

CLYDE SUITE

DIMENSIONS

Length x Width x Height
29.6 x 19.1 x 4.54

ENTRANCE

1.6w x 1.9h metres
(approx.)

QUEEN MARY

DIMENSIONS:

Length x Width x Height
19.1 x 14.8 x 4.54

ENTRANCE:

1.6w x 1.9h metres (approx.)

QUEEN ELIZABETH SUITE

DIMENSIONS:

Length x Width x Height:
19.1 x 14.8 x 4.54

ENTRANCE:

1.6w x 1.9h metres (approx.)

QUEEN ELIZABETH 1 OR 2

DIMENSIONS:

Length x Width x Height:
14.8 x 9.5 x 4.54

ENTRANCE:

1.6w x 1.9h metres (approx.)

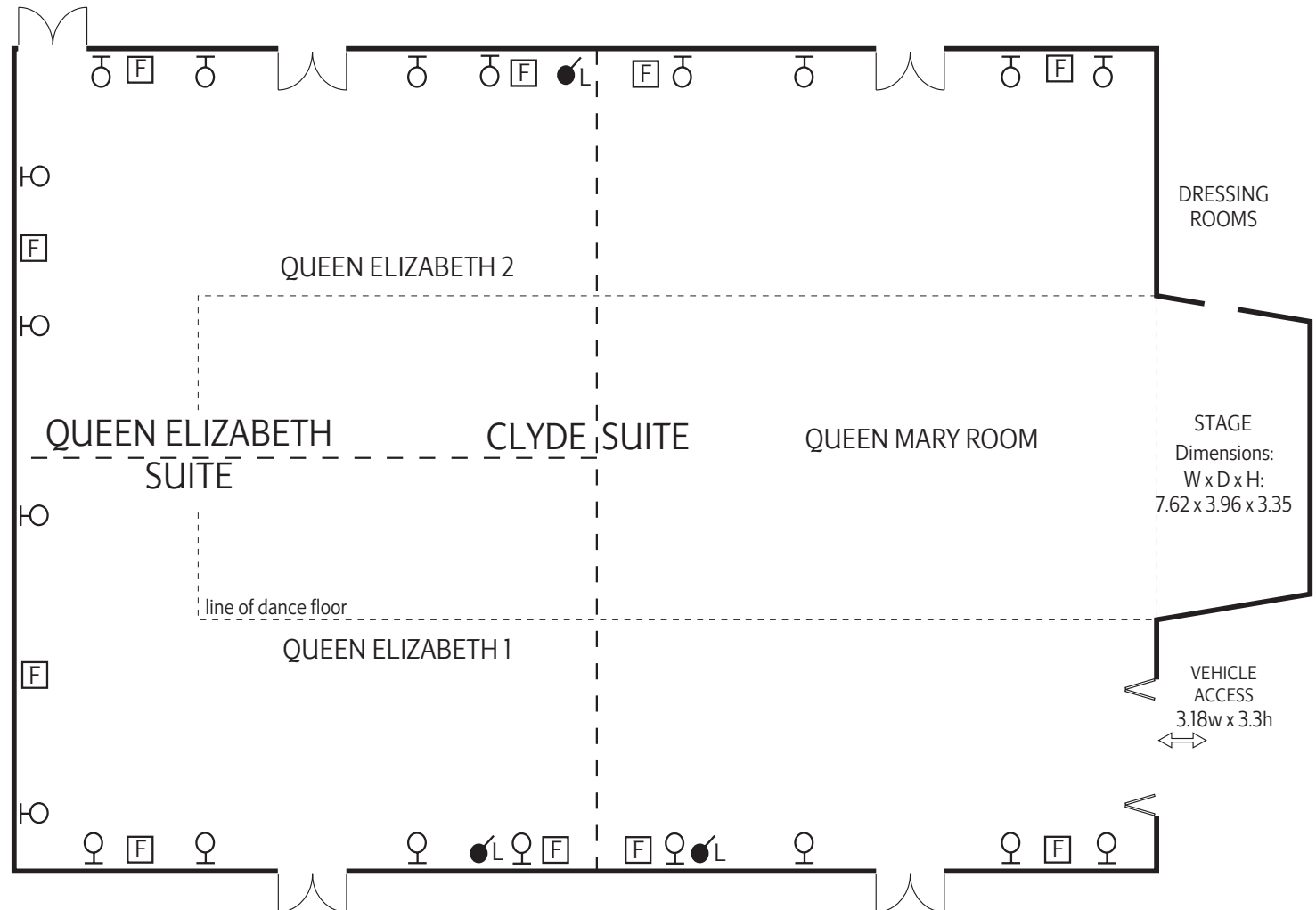

WAVERLEY ROOM

DIMENSIONS

Length x Width x Height:
11.92 x 6.28 x 3.75

ENTRANCE

1.35w x 1.95h metres (approx.)

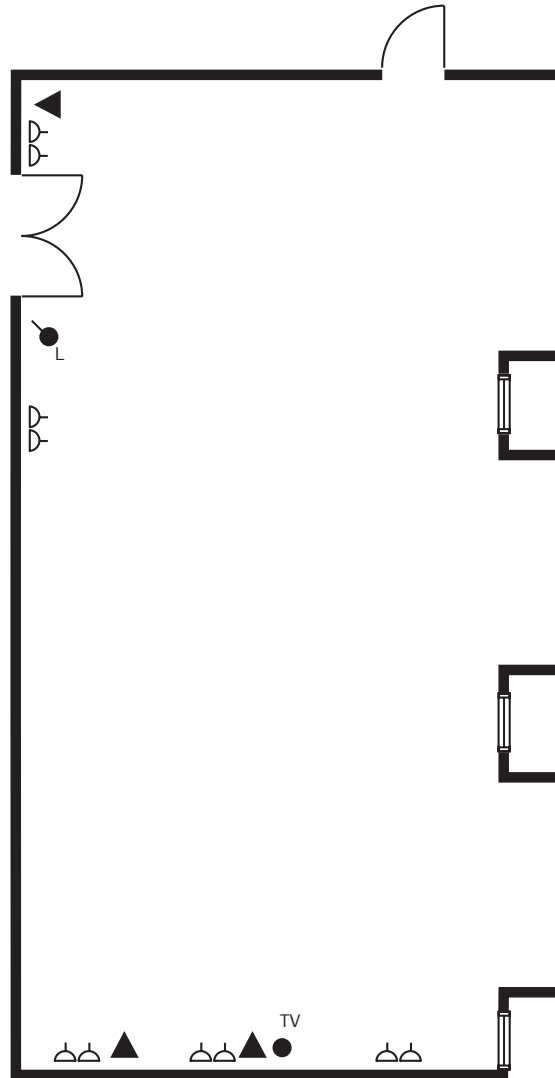

FIRST FLOOR MEETINGS ROOMS

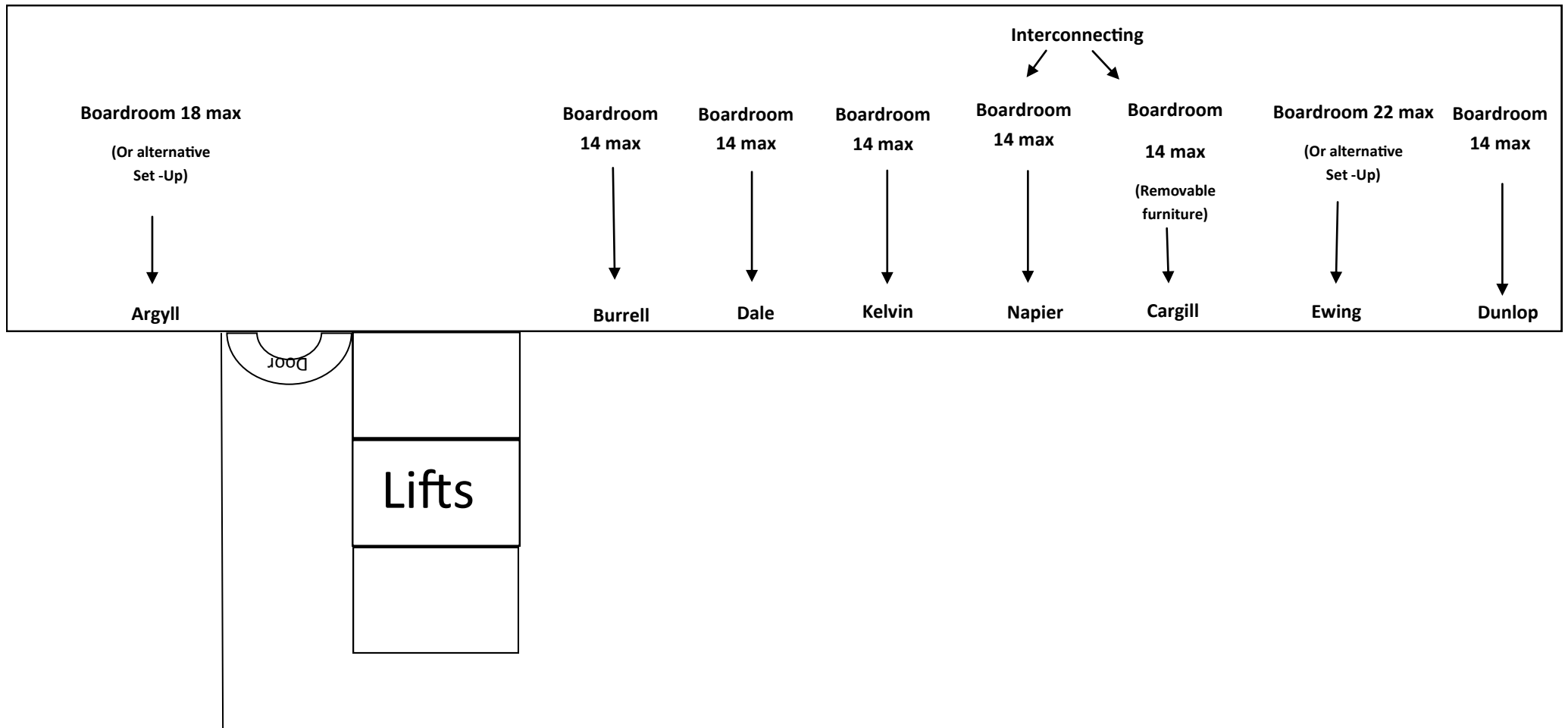

TYPICAL SYNDICATE ROOM

DIMENSIONS

Length x Width x Height:
5.34 x 3.54 x 2.35 (approx)

ENTRANCE

0.78 x 1.95 metres (approx.)

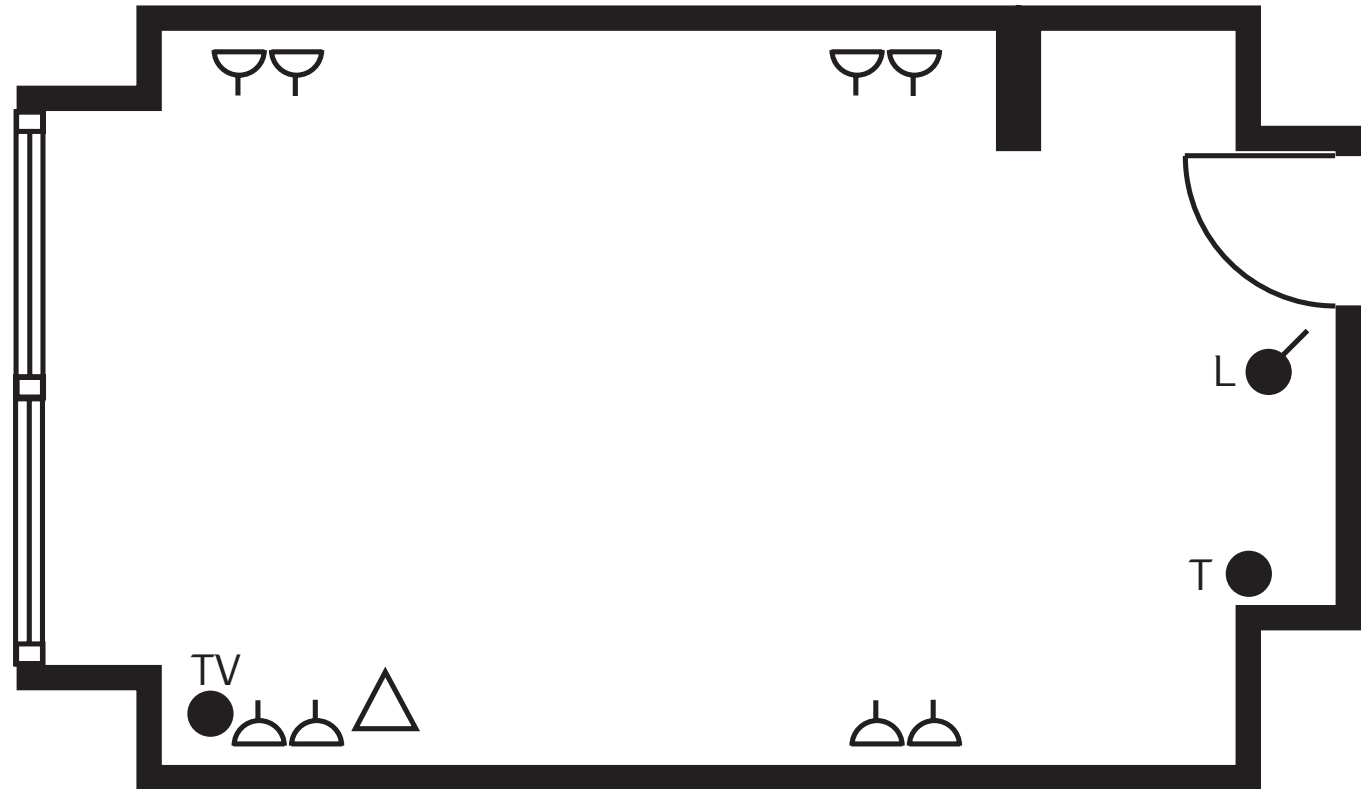

ARGYLL ROOM

DIMENSIONS

Length x Width x Height:
7.4 x 4.99 x 2.35

ENTRANCE

0.78w x 1.95h metres (approx.)

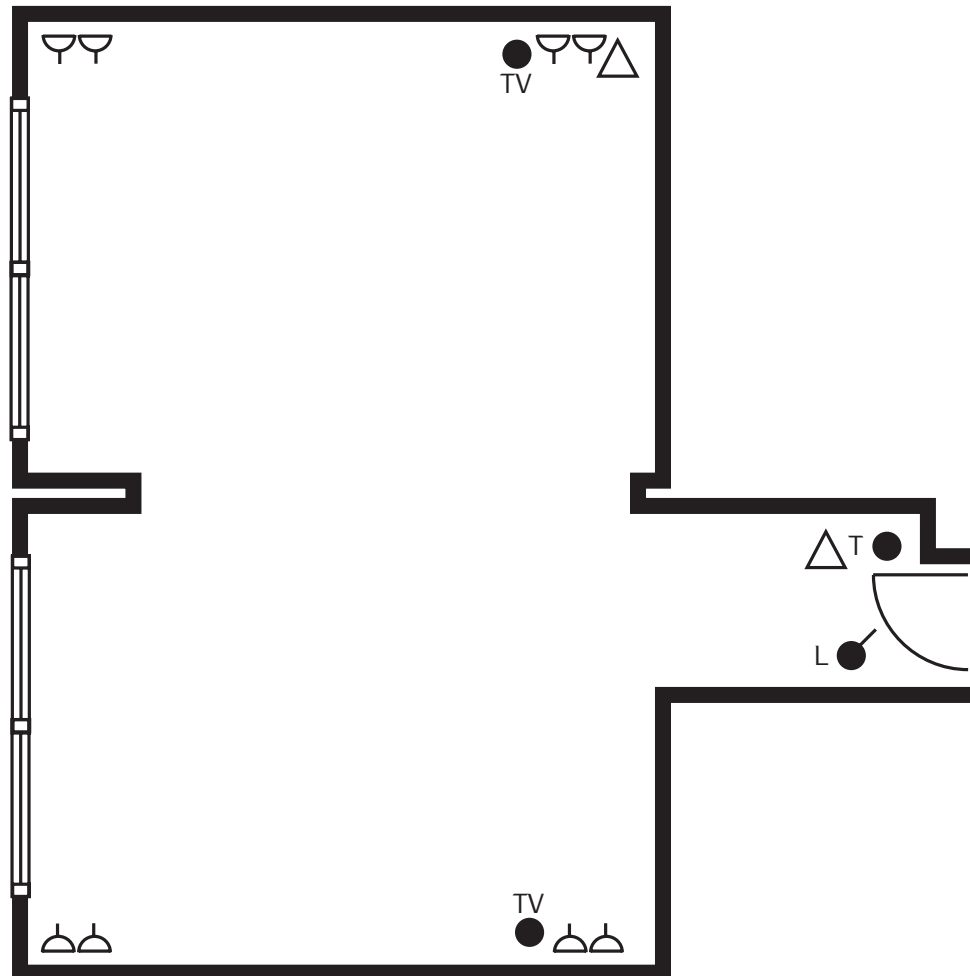

EWING ROOM

DIMENSIONS

Length x Width x Height:
7.46 x 4.99 x 2.35

ENTRANCE

0.78w x 1.95h metres (approx.)

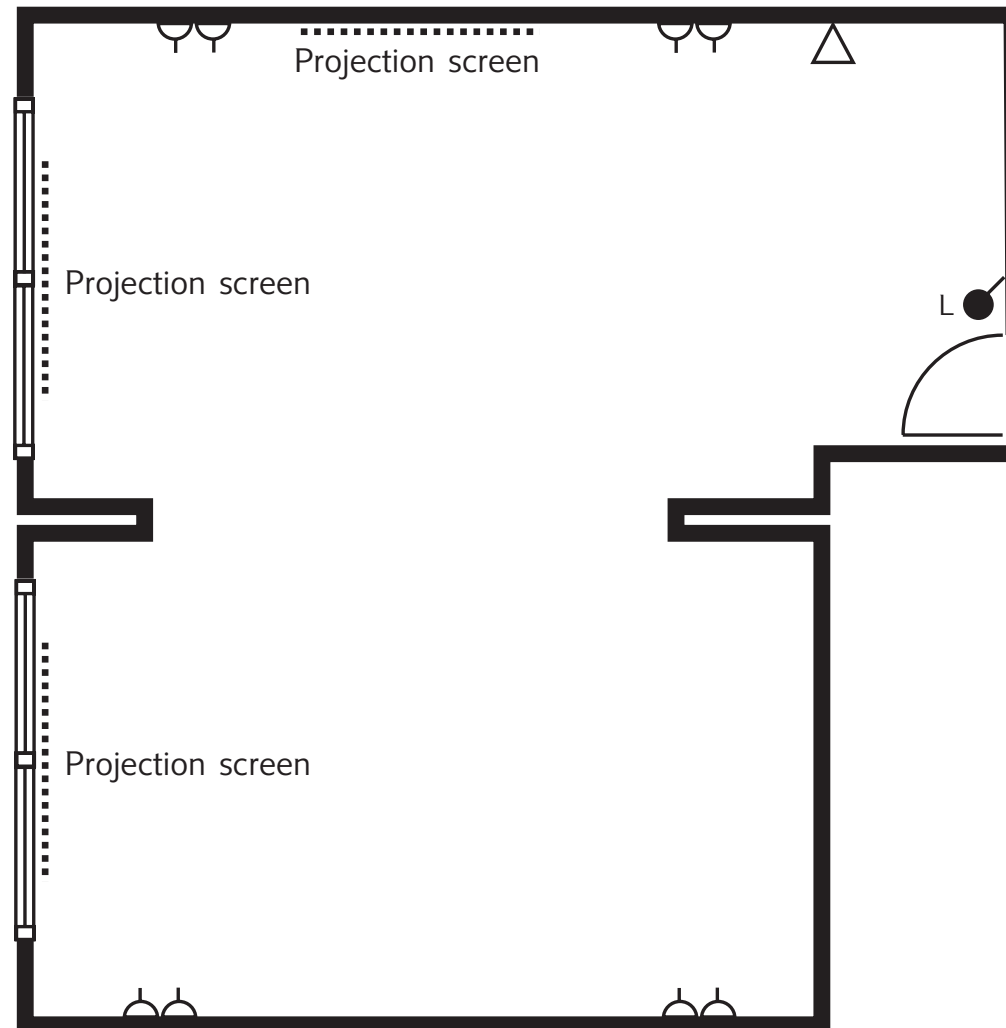

DRUMMOND ROOM

DIMENSIONS

Length x Width x Height:
7.36 x 5.2(min.) x 2.35

ENTRANCE

1.46w x 1.95h metres
(approx.)

